

1. BURR OF BRACKET SHOULD BE MINIMIZED.
2. BRACKET SHOULD BE FREE OF SHARP EDGES.
3. UNSPECIFIED RADIUS WOULD BE 0.5MM.
4. IMPORTANT PARTS ARE MARKED BY ASTERISK.
5. SAMPLE APPROVAL IS REQUIRED.

0 ~ 10	+/- 0.20
11 ~ 25	+/- 0.25
26 ~ 38	+/- 0.30
39 ~ 50	+/- 0.40
OVER 50	+/- 0.50

ITEM NO.	H161 - 10
DESCRIPTION	ZIPLOCK CARABINER
MATERIAL	ALU6061 - T6, T = 2MM
WEIGHT	1.20g
DATE	14/JAN/2025

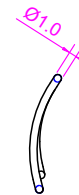
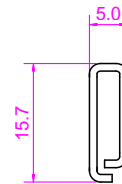
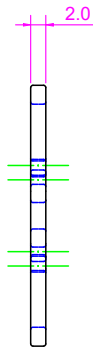
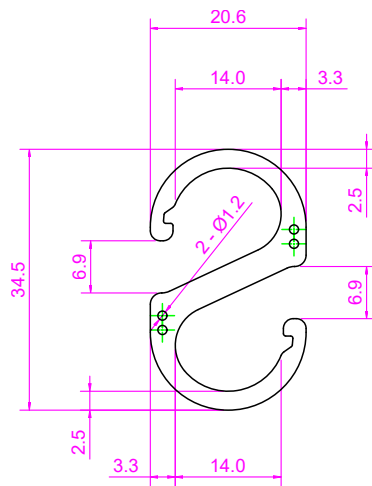

**SPRING**

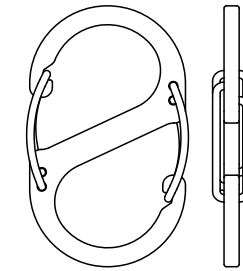

**ASSEMBLY VIEW**  
**SCALE 1:1**

### 3D DRAWING



### NOTES

1. BURR OF BRACKET SHOULD BE MINIMIZED.
2. BRACKET SHOULD BE FREE OF SHARP EDGES.
3. UNSPECIFIED RADIUS WOULD BE 0.5MM.
4. IMPORTANT PARTS ARE MARKED BY ASTERISK.
5. SAMPLE APPROVAL IS REQUIRED.

### GENERAL TOLERANCES (mm)

0	~ 10	+/- 0.20
11	~ 25	+/- 0.25
26	~ 38	+/- 0.30
39	~ 50	+/- 0.40
OVER 50		+/- 0.50

### INFORMATION

ITEM NO.	H161 - 15
DESCRIPTION	ZIPLOCK CARABINER
MATERIAL	ALU6061 - T6, T = 2MM
WEIGHT	1.20g
DATE	17/JAN/2025